

## Extended rest kits



MDG series depth gage with optional extended rest kit used to provide additional frame clearance

Part # MDGRK2  
Rest kit, 2" Tall

FRAME CLEARANCE	PART #
1.5"	MDGRK1
2"	MDGRK2
2.5"	MDGRK3



1.5" x 1.5" Heavy Duty tube 3.5 lbs per ft.



Gaging pins 7/16" Dia.

MAX GAGING DEPTH	PIN LENGTH	SOLID PIN PART #	THREADED PIN PART #
2"	5.5"	MDGP2	MDGPT2
4"	7.5"	MDGP4	MDGPT4
6"	9.5"	MDGP4	MDGPT4
10"	13.5"	MDGP10	MDGPT10
12"	15.5"	MDGP12	MDGPT12
16"	19.5"	MDGP16	MDGPT16
20"	23.5"	MDGP20	MDGPT20
24"	27.5"	MDGP24	MDGPT24
30"	33.5"	MDGP30	MDGPT30
36"	39.5"	MDGP36	MDGPT36

BAR LENGTH	HEAVY DUTY FRAME
	PART #
13.25"	MDGHT13
15.75"	MDGHT15
18.38"	MDGHT18
21.00"	MDGHT21
26.25"	MDGHT30
31.50"	MDGHT40
39.36"	MDGHT47
47.23"	MDGHT49

## Indicator Housing Assemblies

Adjustable self mastering indicator housing assembly

**push down**

(Indicator not included)

AGD 1 Part #MDGPD1

AGD 2 Part #MDGPD2

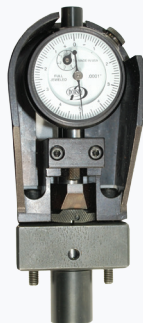

Adjustable self mastering indicator housing assembly

**push up**

(Indicator not included)

AGD 1 Part #MDGPU1

AGD 2 Part #MDGPU2



Fixed series self mastering indicator housing assembly for AGD # 1, #2 or digital indicators

(Indicator not included)

Part #MDGF



## REVERSIBLE THREAD IN CONTACT

Requires MGPT series threaded pin

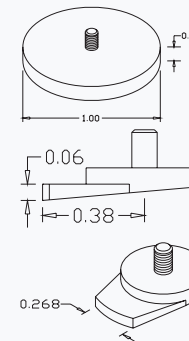

PART #	DESCRIPTION
5615	1" Disc Contact
5616	.75" Reversible Contact