

SNAP GAGE ASSEMBLY FOR BALL MEASUREMENTS

Measuring balls and other spherical items is one of the most popular applications of the Versatile Snap Gage. Two snap gage frames, 0-1" (Part #48554) and 1"-2" (Part #48555) cover the range of ball diameters from the smallest manufactured up to 2" diameter. The "V" backstops have been specially designed to facilitate the measurement of balls.



Ball checking gage shown is comprised of gage (part #48554), carbide tapered flat contacts (part #48548), work support (part #48569), work support adjustment assembly (part #48581), and bench stand (part #48502-V)

Work Support Note: Work support adjustment assembly part #48581 must be used with work support No.1 through No.6

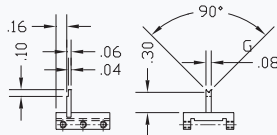

Work support No.1
Part #48568
.060" - .100" balls

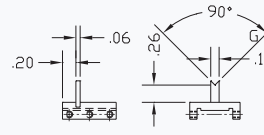

Work support No.2
Part #48569
.100" - .160" balls

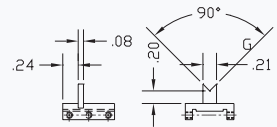

Work support No.3
Part #48570
.160" - .250" balls

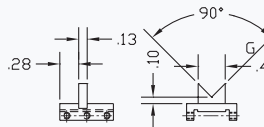

Work support No.4
Part #48571
.250" - .500" balls

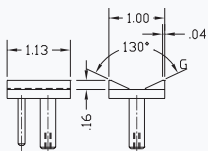

"V" block screw controlled backstop
Part #48583
1.000" - 2.000" balls

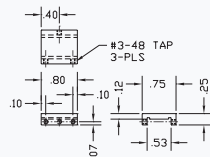

Work support blank
Part #48582

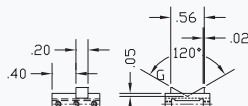

Work support No.5
Part #48572
.500" - 1.000" balls

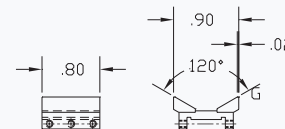

Work support No.6
Part #48574
1.000" - 1.750" balls

